



## GD1000-2 2V1000AH GD SERIES-Deep Cycle Battery

### Applications

- ◆ Electric tools
- ◆ Vehicle in place of walking
- ◆ Lawn mowers
- ◆ Golf trolleys and golf cart
- ◆ Portable apparatus, lights and instruments;
- ◆ Electric toys
- ◆ Illumination light
- ◆ Fire alarms
- ◆ Portable power
- ◆ Wheelchairs
- ◆ Solar energy systems
- ◆ Marine
- ◆ RV
- ◆ Medical equipments.

ISO 9001	ISO 14001	OHSAS 18001	TLC
CE	RoHS	UL	POV

### Specification

Nominal Voltage	2V	
Nominal Capacity(10HR)	1000.0AH @10hr-rate to 1.80V per cell @25°C	
Dimension	Length	475±3mm (18.70 inches)
	Width	175±3mm (6.89 inches)
	Container Height	328±3mm (12.91 inches)
	Total Height (with Terminal)	350±3mm (13.78 inches)
Approx Weight	Approx 52.0 Kg (114.64 lbs)	
Terminal	T11	
Container Material	ABS	
Max. Discharge Current	4000A (5s)	
Internal Resistance	Approx 0.55mΩ	
Operating Temp.Range	Discharge	-20~60°C (-4~140°F)
	Charge	0~50°C (32~122°F)
	Storage	-20~60°C (-4~140°F)
Nominal Operating Temp. Range	25±5°C (77±41°F)	
Float charging Voltage	2.27 to 2.3 VDC/unit Average at 25°C	
Recommended Maximum Charging Current Limit	200 A	
Equalization and Cycle Service	2.43 to 2.47 VDC/unit Average at 25°C	
	40°C (104°F)	103%
	25°C (77°F)	100%
Capacity affected by Temperature	0°C (32°F)	86%
	JYC GD series battery may be stored for up to 6 months at 25°C(77°F) and then a freshening charge is required. For higher temperatures the time interval will be shorter.	
	Self Discharge	

### Constant Current Discharge Characteristics: A (25°C)

F.V/Time	15MIN	30MIN	1HR	2HR	3HR	4HR	5HR	6HR	8HR	10HR
1.60V	1358	1001	624.4	383.0	285.3	204.7	179.2	160.9	129.8	104.2
1.65V	1291	961.4	616.5	369.1	273.3	197.5	177.4	157.0	124.0	103.2
1.70V	1204	906.3	604.5	363.1	267.3	195.7	174.8	153.1	122.1	102.2
1.75V	1069	815.6	556.6	343.1	253.4	184.9	172.6	145.4	118.2	101.1
1.80V	920.0	742.9	524.7	327.2	243.4	183.1	169.6	143.4	116.3	100.1
1.85V	778.1	668.8	484.8	309.2	231.4	168.8	159.6	135.7	110.5	94.02

### Constant Power Discharge Characteristics: W(25°C)

F.V/Time	15MIN	30MIN	1HR	2HR	3HR	4HR	5HR	6HR	8HR	10HR
1.60V	2377	1825	1162	716.7	531.7	384.6	356.2	310.4	247.1	207.5
1.65V	2315	1815	1156	706.3	521.2	378.9	352.9	306.4	245.0	205.6
1.70V	2187	1718	1144	696.0	513.3	377.4	348.7	299.3	241.2	204.3
1.75V	1948	1548	1073	658.8	494.9	358.5	343.8	284.5	233.6	202.3
1.80V	1686	1412	1021	629.2	474.4	356.9	337.8	281.2	229.9	200.6
1.85V	1438	1273	946.8	595.6	451.9	330.6	318.7	266.4	218.4	189.0

Note The above data are average values, and can be obtained with 3 charge/discharge cycles. These are not minimum values.



## GD1000-2 2V1000AH GD SERIES-Deep Cycle Battery

### Dimensions

#### T11 Terminal Unit: mm [inches]

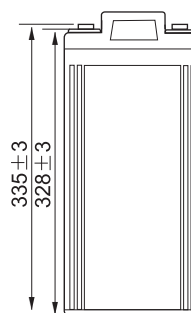
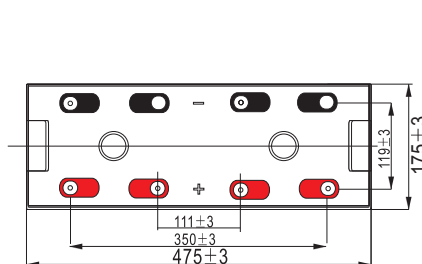
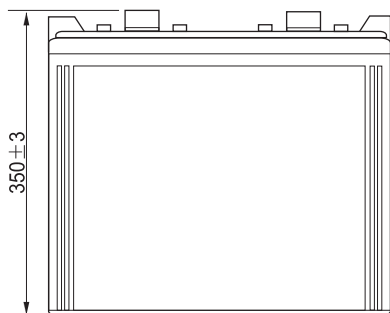
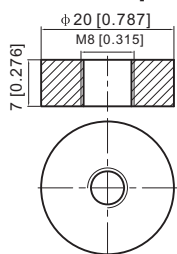

### Life characteristics of cyclic use

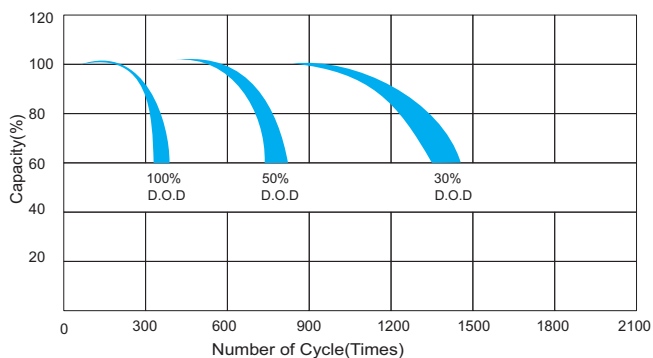

### Storage characteristic

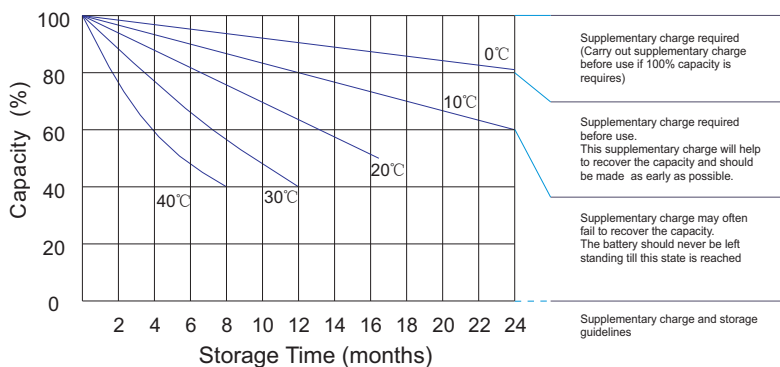

### Charge characteristic Curve for standby use

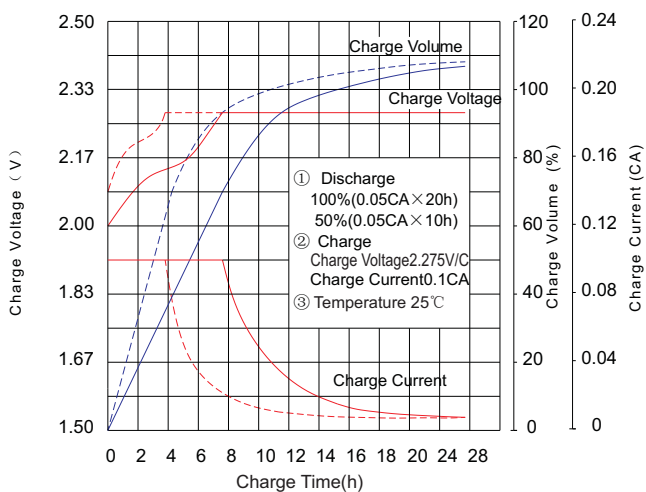

### Discharge characteristic Curve

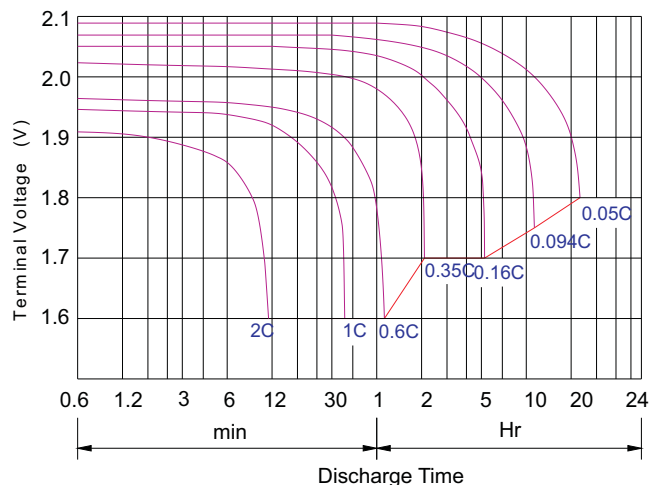

### JYC GD BATTERIES

This information is generally descriptive only and is not intended to make or imply any representation, guarantee or warranty with respect to any cells and batteries. Cell and battery designs/ specification are subject to modification without notice. Contact JYC for the latest information.